



Library Garden  
Photoshop

reTHINKING Briggs Library

**Location:** SDSU  
Brookings, SD  
**Size:** 30,000 SF  
**Date:** Spring 2017  
**Project Time:** 10 wk

**Scope of Services:**

Take the progressive learning styles and ideal study space that embodies what a library is; planning, and re-designing the 30,000 SF main floor. The development of the design is driven to provide strategic and

*Great use of concise. but impactful text*

master planning, programming, and design to continue to reinforce the technology progressive and forward thinking that Briggs Library is striving for and their goals.

**Concept**

Create a main floor library sanctuary that is characterized by **exposed revitalization** using repetition and rhythm. Reinterpret a traditional renaissance Italian garden and implement it into the floor plan.

**Goals**

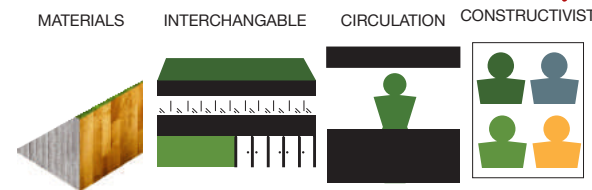

*Show more than renderings!*

**Floor Plan**





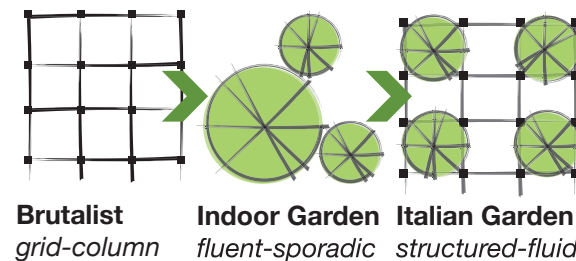

*We love diagrams!*

**Precedent Progression**



**Constructivist Theory**

how people construct their comprehension and perceptions of the world. how different people learn; 4 different categories

-   
**1. INDIVIDUAL**  
 private & semi private study
-   
**2. OBSERVER**  
 sight-lines to other groups
-   
**3. TEAM LEARN**  
 group study
-   
**4. NOMAD**  
 circulate between other groups